



OTTAWA COUNTY WATER RESOURCES COMMISSIONER

Joe Bush

12220 Fillmore Street
West Olive, Michigan 49460

**GRAND TRUNK DRAIN; VANDERWALL DRAIN; SHEFFIELD DRAIN;
SUMMERLIN NORTH DRAIN; BROOKVIEW DRAIN; BROOKWOOD DRAIN;
FAIRFIELD FARMS DRAIN; REGENCY LAKE ESTATES DRAIN; and
SUMMER GROVE DRAIN**

**NOTICE OF DAY OF REVIEW OF APPORTIONMENTS AND
REVIEW OF DRAINAGE DISTRICT BOUNDARIES**

DATE: Wednesday, July 21, 2021
TIME: 9:00 a.m. to 5:00 p.m.
LOCATION: Ottawa County Water Resources Commissioner's Office
12220 Fillmore Street
Room 141
West Olive, MI 49460
QUESTIONS: (616) 994-4530

The Ottawa County Water Resources Commissioner will hold a Day of Review of Apportionments and Review of Drainage District Boundaries on the above date, time, and location. The Day of Review is an opportunity to review the tentative apportionments of benefit for each parcel and municipality within the drainage districts. Maps of the proposed drainage district boundary revisions can be found enclosed with this Notice and on the Water Resources Commissioner's website at: <https://www.miottawa.org/departments/drain/>

The Water Resources Commissioner, engineers and/or other staff members will be available to assist individuals throughout the day and make revisions to the boundaries or apportionments where necessary. There is no need to schedule an appointment for a specific time on the Day of Review. The computation of costs for the drains will also be available at the Day of Review. Drain assessments are collected in the same manner as property taxes and will appear on your winter tax bill. If drain assessments are being collected for more than one (1) year, you may pay the assessment in full with any interest to date at any time and avoid further interest charges.

Persons with disabilities needing accommodations for effective participation in the Day of Review should contact the Water Resources Commissioner's Office at the number noted above (voice) or through the Michigan Relay Center at 7-1-1 (TDD) at least 24 hours in advance of the Day of Review to request mobility, visual, hearing, or other assistance.

Comments on the apportionment of benefits and drainage district boundaries may be submitted to the Water Resources Commissioner in writing before the date of the Day of Review to 12220 Fillmore Street, Room 141, West Olive, MI 49460, or electronically to waterresourcescommissioner@miottawa.org. Comments may also be submitted in writing or verbally at the Day of Review. Comments submitted in advance must be received by the Water Resources Commissioner prior to the Day of Review to ensure consideration.

You may appeal the Water Resources Commissioner's decision to revise the district boundaries to the Ottawa County Circuit Court within ten (10) days, and you may also appeal the determination of apportionments to the Ottawa County Probate Court within ten (10) days.

The following is a list of any county, township, city, and village to be assessed at large in Ottawa County in each of the drainage districts:

Grand Trunk Drain

Ottawa County
Crockery Township

Vanderwall Drain

Ottawa County
Spring Lake Township
Crockery Township

Sheffield Drain

Ottawa County
Allendale Charter Township

**Summerlin North Drain, Brookview Drain, Brookwood Drain, Fairfield Farms Drain,
Regency Lake Estates Drain, and Summer Grove Drain**

Ottawa County
Holland Charter Township

Descriptions of the lands constituting the drainage districts can be found on maps posted on the Water Resources Commissioner's website at <https://www.miottawa.org/departments/drain/>

The following additional information can be found for the Summerlin North Drain in the Notice of Letting posted on the Water Resources Commissioner's website at <https://www.miottawa.org/departments/drain/>:

- Number and length of sections, the average width of each section, and if the drain will be closed, the amount and specifications of all tile or pipe required;
- Location, number, type, and size of culverts or bridges to be installed, if any; and
- Conditions upon which the contract will be awarded.





Joe Bush
Ottawa County Water Resources Commissioner

OTTAWA COUNTY
 WATER RESOURCES COMMISSIONER
 ALLENDALE CHARTER TOWNSHIP
 SECTIONS 20 & 29

SHEFFIELD DRAIN DRAINAGE DISTRICT

Prein&Newhof
 2190678

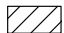
LEGEND

-  Revised Drainage District Boundary
-  Historic Drainage District Boundary
-  Lands Added
-  Lands Removed
-  Route and Course
-  Other County Drains

DRAIN INFORMATION

Historic District:	320.53 acres
Revised District:	256.41 acres
Lands Added:	25.81 acres
Lands Removed:	89.93 acres
Drain Length:	1.28 miles

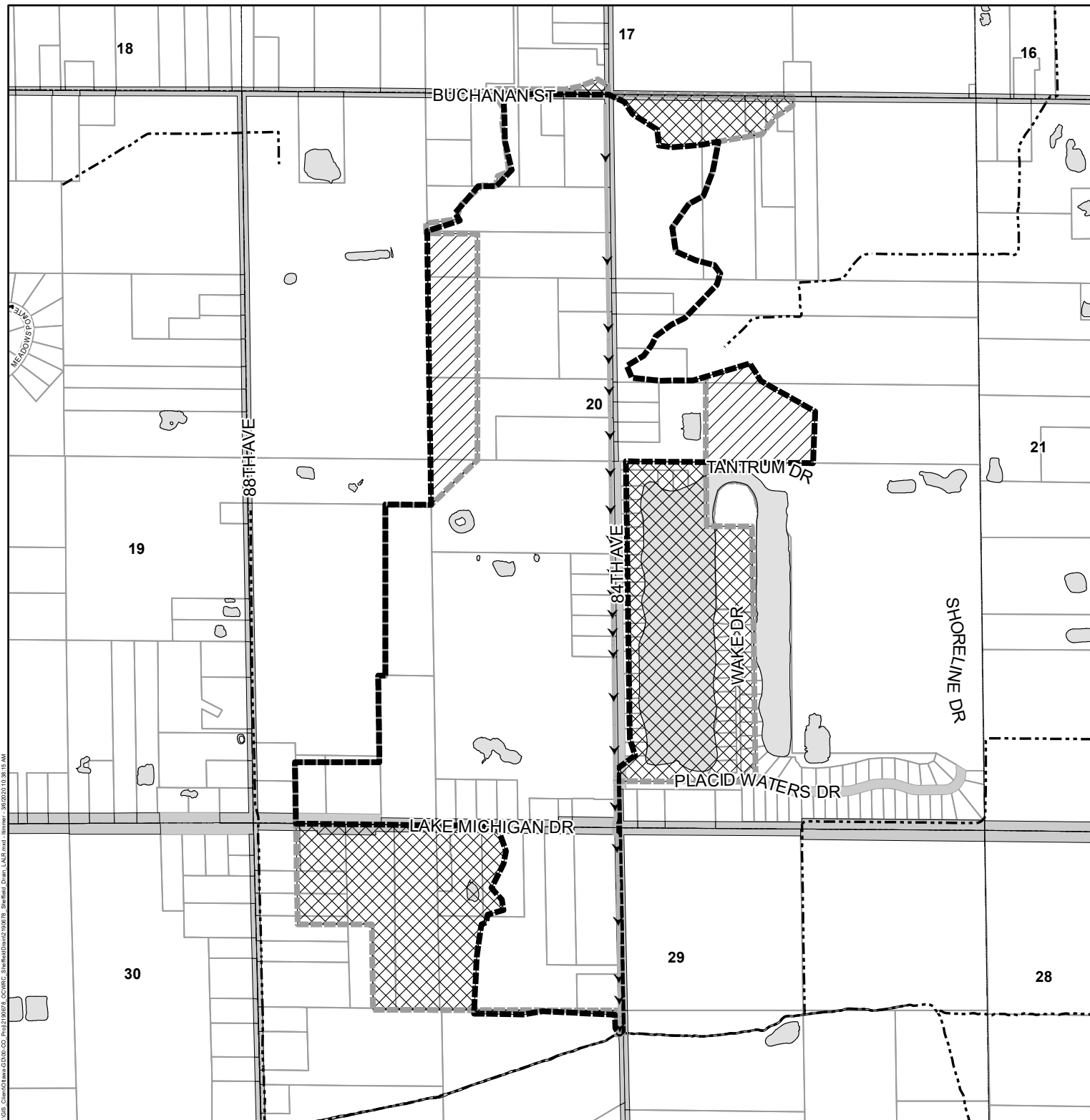

SCALE: 1" = 1,000'

**OTTAWA COUNTY
WATER RESOURCES COMMISSIONER**







SPRING LAKE TOWNSHIP SECTIONS 12 & 13
CROCKERY TOWNSHIP SECTION 7

VANDERWALL DRAIN DRAINAGE DISTRICT

Prein&Newhof

2200367

LEGEND

-  Revised Drainage District Boundary
-  Historic Drainage District Boundary
-  Lands Added
-  Lands Removed
-  Route and Course
-  Other County Drains
-  Other Watercourses

DRAIN INFORMATION

Historic District:	73.06 acres
Revised District:	155.24 acres
Lands Added:	97.37 acres
Lands Removed:	15.19 acres
Drain Length:	0.68 miles

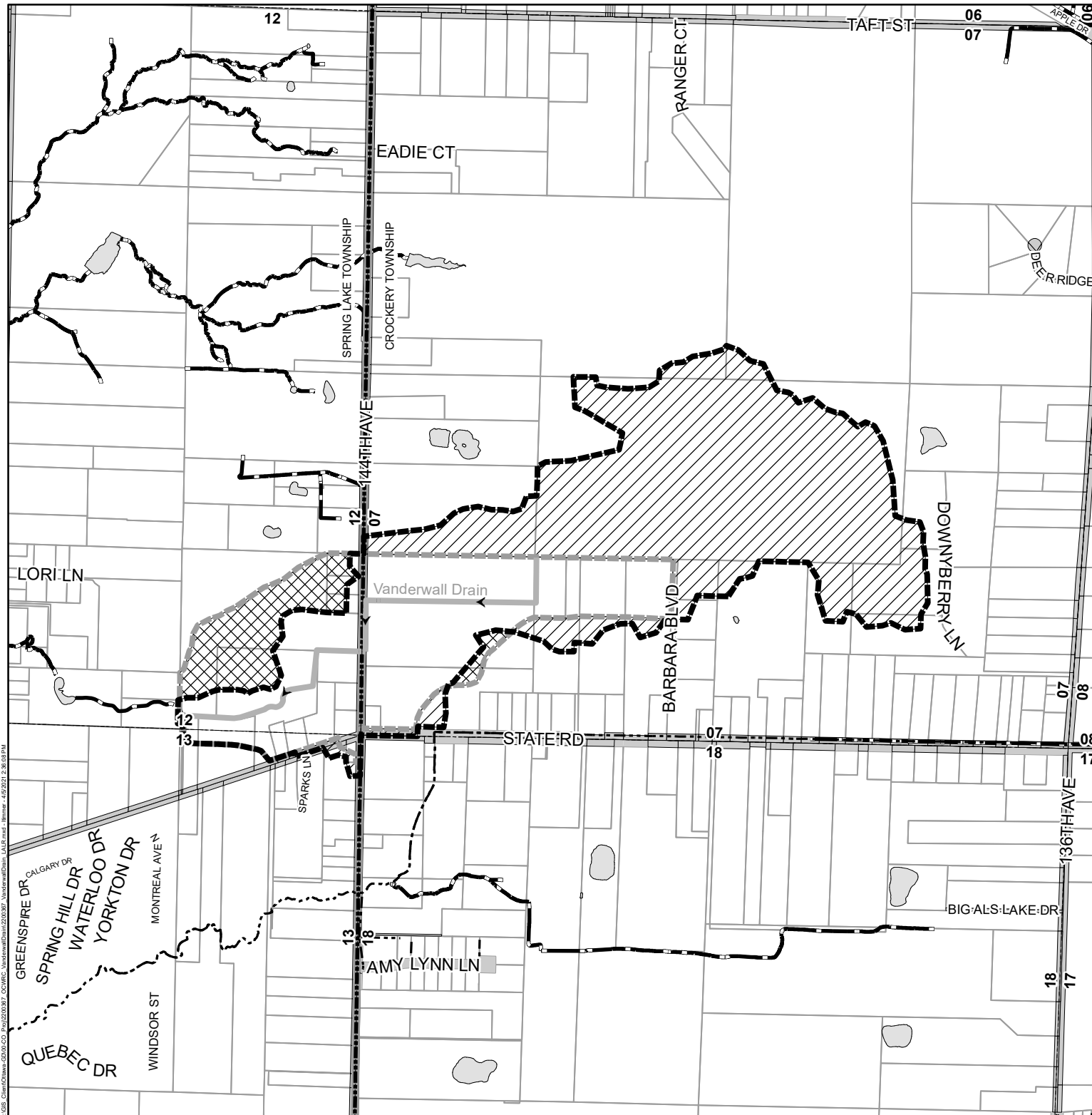













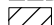

SCALE: 1" = 1,000'

JGIS Client:G:\Data\GIS\Projects\2200367_VanderwallDrain\Map\Map.mxd - Items - #452037 2:58:08 PM

**OTTAWA COUNTY
WATER RESOURCES COMMISSIONER**
HOLLAND CHARTER TOWNSHIP
SECTIONS 6 & 7
**SUMMERLIN NORTH DRAIN
DRAINAGE DISTRICT**

Prein&Newhof
2190680

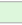
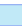
LEGEND

-  REVISED DRAINAGE DISTRICT BOUNDARY
-  HISTORIC DRAINAGE DISTRICT BOUNDARY
-  LANDS ADDED
-  LANDS REMOVED
-  SUMMERLIN NORTH DRAIN - DETENTION FLOW
-  SUMMERLIN NORTH DRAIN - OPEN DRAIN
-  SUMMERLIN NORTH DRAIN - STORM SEWER
-  STORM SEWER
-  WATERCOURSE
-  CATCH BASIN
-  MANHOLE
-  EASEMENT
-  SUMMERLIN NORTH DETENTION POND
-  PLAT BOUNDARIES
-  SECTION BOUNDARY

DRAIN INFORMATION

Historic District:	24.37 acres
Revised District:	23.44 acres
Lands Added:	1.14 acres
Lands Removed:	2.07 acres
Drain Length:	0.80 miles

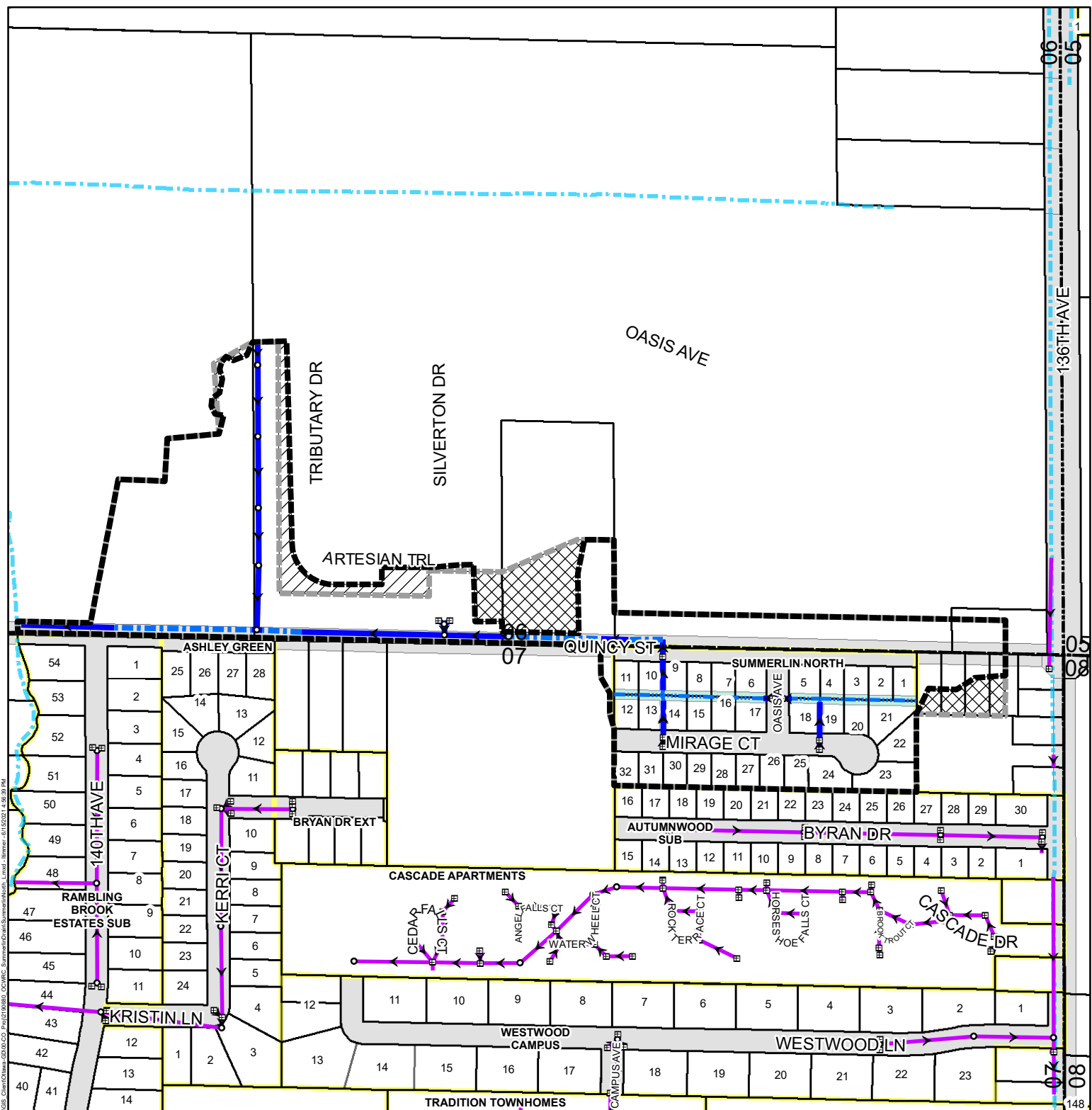

SCALE: 1" = 400'

J:\GIS\Drawings\GISD\CD\1401191800_COC\REC_SummerlinNorth\SummerlinNorth.dwg 11/20/2014 4:58:33 PM

FAQs

Joe Bush
Ottawa County
Water Resources Commissioner



FREQUENTLY ASKED QUESTIONS about the Day of Review of Drainage District Boundaries and Review of Apportionments

What is a Day of Review of District Boundaries?

The Michigan Legislature passed a law in 2013 to allow revisions to historical drainage district boundaries when recommended by a licensed engineer.

Property owners can review changes with the Drain Office staff during the Day of Review. The proposed boundary revisions can be found on the map included with the notice you received and in more detail at the Ottawa County Water Resources Commissioner's website

at:

<https://www.miottawa.org/departments/drain/>

What is a Drainage District?

A drainage district is the land area that benefits from the drain. The drainage district makes up the watershed that contributes water to the drain. Each property and municipality within the drainage district pays for maintenance and improvement of the drain.

Why are the boundaries being revised?

Revisions are recommended because the historic drainage district boundaries do not accurately reflect the current watershed of the drain.

What is a Day of Review of Apportionments?

A Day of Review of Apportionments provides an opportunity for property owners to review the percent of benefit of the drain assigned to their property. The apportionments of benefit are based on acreage, land use, and other factors. The apportionments determine the assessment amount for each property for costs of construction or maintenance.

Why are the apportionments being revised?

Parcel apportionments are being revised to more accurately reflect the percentage of benefit that each property receives from the drain.

If a parcel is on the outer boundary of a drainage

district, it is possible that only a portion of the parcel will be assessed.

Why did I receive a notice?

Notices went out to the following property owners:

- **Properties being added to the Drainage District.** The properties were not previously in the drainage district, but the engineers determined that the properties are within the drain's watershed.
- **Properties being removed from the Drainage District.** The properties were previously in the drainage district, but the engineers determined that the properties are not in the drain's watershed.
- **Properties currently in the Drainage District and proposed to remain in the Drainage District.** There is no change in terms of boundaries for these properties.

All property owners subject to an assessment were sent a copy of the notice.

When do I receive my drain assessment?

Drain assessments are included on your Winter Tax bill, and are only levied when costs are incurred for the drain. Assessment amounts vary from year to year.

What is my assessment amount?

If your property is subject to an assessment, estimated assessment amounts are included in your notice, and are also available at the Day of Review.

Do I have to attend the Day of Review?

You are not required to attend the Day of Review.

How can I get more information?

Visit our website at

<https://www.miottawa.org/departments/drain/> or call (616) 994-4530.

Joe Bush

Ottawa County Water Resources Commissioner | 12220 Fillmore St. | West Olive, MI 49460 | (616) 994-4530